

# INSTRUCTION BOOK

MODEL **S750**

# "IMPORTANT SAFETY INSTRUCTIONS"

"Your sewing machine is designed and constructed only for HOUSEHOLD use."

"Read all instruction before using this sewing machine."

## "DANGER — To reduce the risk of electric shock:"

1. "An appliance should never be left unattended when plugged in. Always unplug this appliance from the electric outlet immediately after using and before cleaning."
2. "Always unplug before relamping. Replace bulb with same type rated 15 Watts."
3. "Do not reach for the appliance that has fallen into water. Unplug immediately."
4. "Do not place or store appliance where it can fall or be pulled into a tub or drop into water or other liquid."

**"WARNING** — To reduce the risk of burns, fire, electric shock, or injury to persons:"

1. "Do not allow to be used as a toy. Close attention is necessary when this appliance is used by or near children."
2. "Use this appliance only for intended use as described in this manual. Use only attachments recommended by the manufacturer as contained in this manual."

3. "Never operate this appliance if it has a damaged cord or plug, if it is not working properly, if it has dropped or damaged, or dropped into water. Return the appliance to the nearest authorized dealer or service center for examination, repair, electrical or mechanical adjustment."

4. "Never operate the appliance with any air openings blocked. Keep ventilation openings of the sewing machine and foot controller free from accumulation of lint, dust, and loose cloth."

5. "Never drop or insert any object into any opening."

6. "Do not use outdoors."

7. "Do not operate where aerosol (spray) products are being used or where oxygen is being administered."

8. "To disconnect, turn all controls to the off ("o") position, then remove plug from outlet."

9. "Do not unplug by pulling on cord. To unplug, grasp the plug, not the cord."

10. "Keep fingers away from all moving parts. Special care is required around the sewing machine needle."

11. "Always use the proper needle plate. The wrong plate can cause the needle to break."

12. "Do not use bent needles."

13. "Do not pull or push fabric while stitching. It may deflect the needle causing it to break."

14. "Switch the sewing machine off ("o") when making any adjustment in the needle area, such as threading needle, changing needle, threading bobbin, or changing presser foot, and the like."

15. "Always unplug the sewing machine from the electrical outlet when removing covers, lubricating, or when making any other user servicing adjustment mentioned in the instruction manual."
16. "Operate sewing machine only when mounted in sewing machine table, case, and the like. See the Installation Instructions."
17. "Connect this appliance to a properly grounded outlet only. See the Grounding Instructions."

## **"SAVE THESE INSTRUCTIONS"**

## **"GROUNDING INSTRUCTIONS"**

"This product must be grounded. In the event of malfunction or breakdown, grounding provides a path of least resistance for electric current to reduce the risk of electrical shock. This product is equipped with a cord having an equipment-grounding conductor and a grounding plug. The plug must be plugged into an appropriate outlet that is properly installed and grounded in accordance with all local codes and ordinances."

## **"DANGER"**

Improper connection of the equipment-grounding conductor can result in a risk of electric shock. The conductor having an outer surface that is green with or without yellow stripes is the equipment-grounding conductor. If repair or replacement of the cord or plug is necessary, do not connect the equipment-grounding conductor to a live terminal."

"Check with a qualified electrician or serviceman if the grounding instructions are not completely understood, or if in doubt as to whether the product is properly grounded."

"Do not modify the plug provided with the product — if it will not fit the outlet, have a proper outlet installed by a qualified electrician."

## TABLE OF CONTENTS

### SECTION I ESSENTIAL PARTS

Names of Parts .....	2 ~ 3
Standard Accessories .....	3
How to Install the Spool Pin .....	4
Fundamentals of Operation .....	4

### SECTION II GETTING READY TO SEW

Connecting the Machine to the Power Supply .....	5
Foot Control .....	5
Replacing Sewing Light .....	5
Thread and Needle Chart .....	6
Changing Needles .....	7
Raising or Lowering the Presser Foot .....	8
To Detach and Attach the Foot Holder, the Finger Guard .....	8
To Snap the Presser Foot On and Off .....	8
Removing the Bobbin .....	9
Setting Spool .....	9
Winding the Bobbin .....	10
Inserting the Bobbin .....	11
Threading the Machine .....	12
Drawing up Bobbin Thread .....	13
Balancing Needle Thread Tension .....	13
Pattern Selector Dial .....	14
Stitch Length Dial .....	14
★ Selecting Stitch Length .....	14
★ Selecting Stretch Stitch Patterns .....	14

★ Dropping the Feed Dogs .....	15
Reverse Stitch Lever .....	15

### SECTION III SEWING

Straight Stitch .....	16
Zigzag Stitch .....	17
Overcasting .....	18
Triple Strength Stitch .....	18
Blind Hemming .....	19
Buttonhole .....	20 ~ 21
Tricot Stitch .....	21
Zipper Application .....	22 ~ 23
Feather Stitch .....	24
Stretch Stitch Patterns .....	24
Rolled Hem .....	25

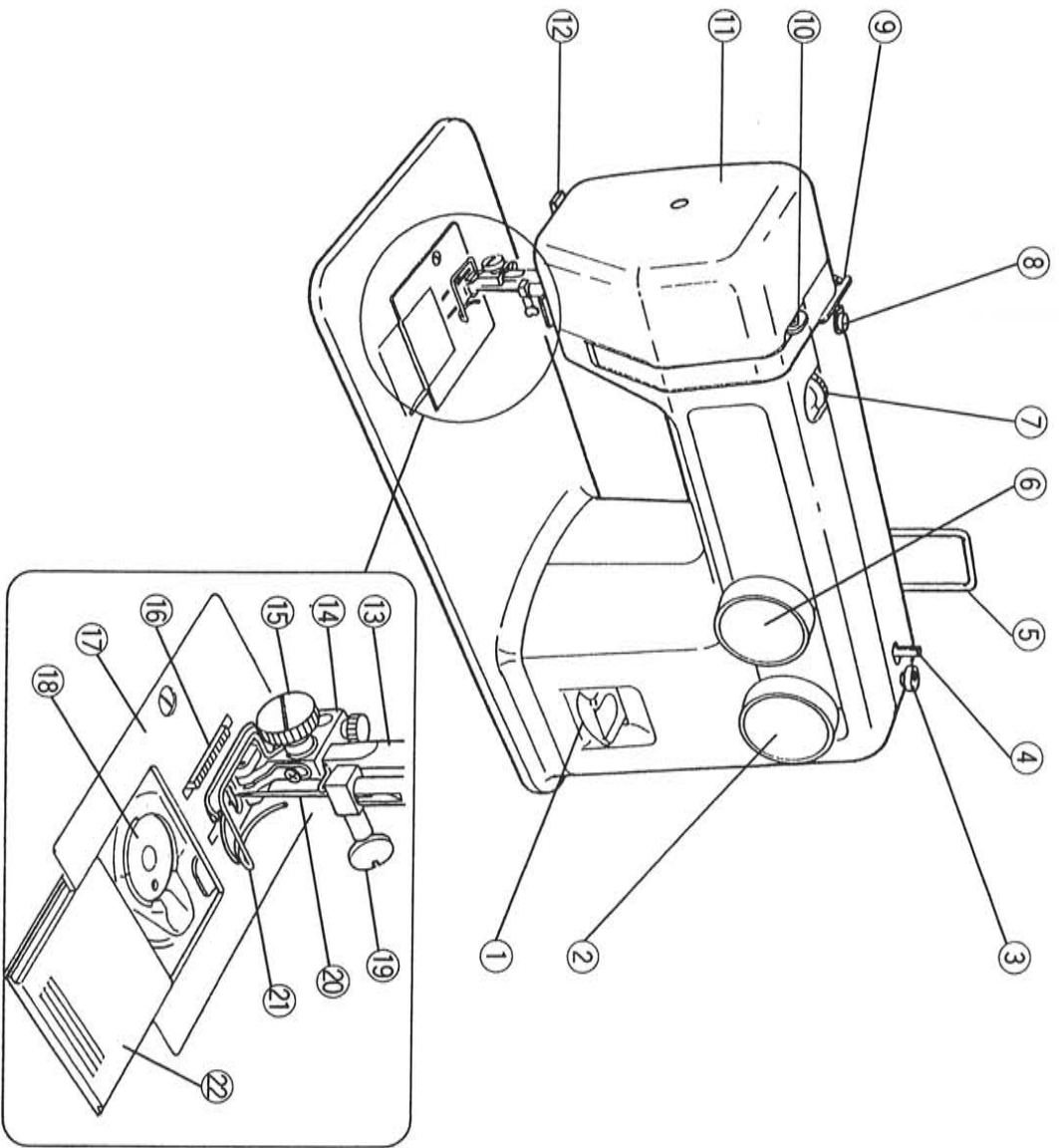
### SECTION IV CARING FOR YOUR MACHINE

Cleaning the Bobbin Holder .....	26
Cleaning the Hook Race and Feed Dog .....	26
Resetting the Bobbin Holder and Needle Plate .....	27
Oiling the Machine .....	28
Trouble Shooting .....	29 ~ 30

**SECTION I ESSENTIAL PARTS**

**• Names of Parts**

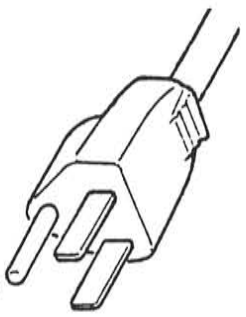
- 1. Reverse stitch lever
- 2. Stitch length dial
- 3. Bobbin winder stopper
- 4. Bobbin winder spindle
- 5. Spool pin
- 6. Pattern selector dial
- 7. Thread tension dial
- 8. Bobbin winder thread guide
- 9. Upper thread guide
- 10. Thread take-up lever
- 11. Face plate
- 12. Thread cutter
- 13. Presser bar
- 14. Foot holder
- 15. Presser foot thumb screw
- 16. Feed dog
- 17. Needle plate
- 18. Bobbin
- 19. Needle clamp
- 20. Needle
- 21. Finger guard
- 22. Slide plate



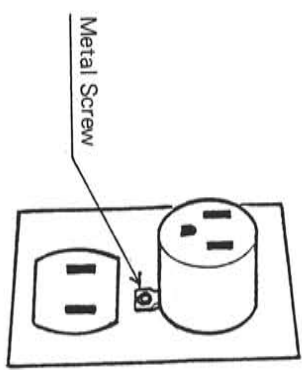
"This sewing machine is for use on a nominal 120 V circuit, and has a grounded plug that looks like the plug as illustrated in Fig. 1. A temporarily adopted, illustrated in Fig. 2 and 3, may be used to connect this plug to a 2-pole receptacle as shown in Fig. 2 if a properly grounded outlet is not available.

The temporarily adopted should be used only until a properly grounded outlet can be installed by a qualified electrician. The green colored rigid ear, lug, and the like, extending from adopter must be connected to a permanent ground such as a properly grounded outlet box cover. Whenever the adopter is used, it must be held in place by the metal screw."

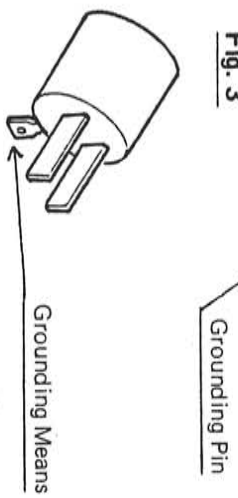
**Fig. 1**



**Fig. 2**

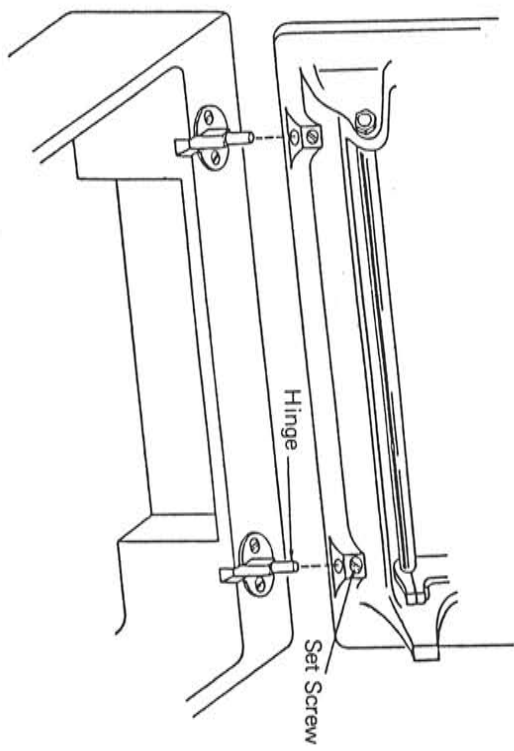


**Fig. 3**



# "INSTALLATION INSTRUCTIONS"

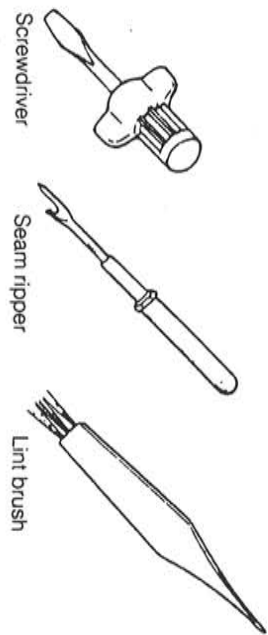
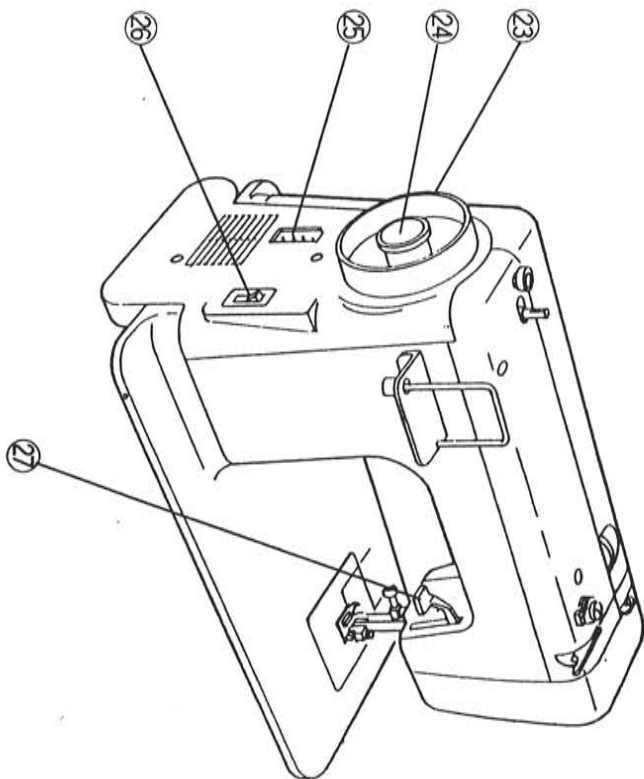
1. Lay the machine backwards with bottom towards you and loosen set screws.
2. After loosening set screws, position and set machine onto hinges.
3. Tighten set screws and swing down machine into place.



Bottom view of machine showing position of hinges

• Standard Accessories

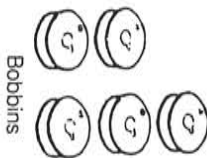
- 23. Balance wheel
- 24. Bobbin winder clutch knob
- 25. Machine socket
- 26. Power switch
- 27. Presser foot lifter



Screwdriver

Seam ripper

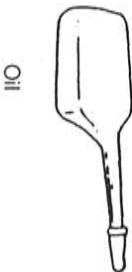
Lint brush



Bobbins



Set of needles



Oil



E: Zipper foot



D: Hemmer foot



C: Overedge foot

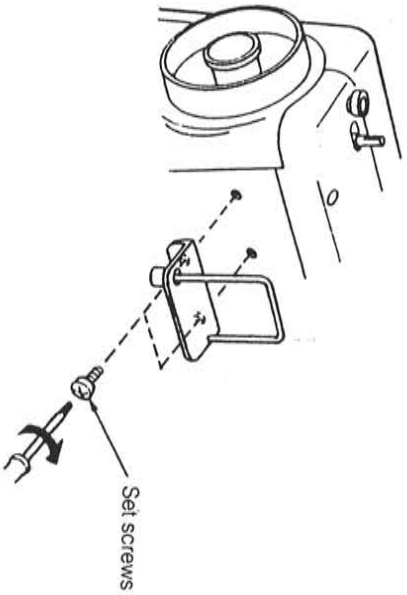


J: Sliding buttonhole foot



G: Blind stitch foot

- **How to Install the Spool Pin**



Spool pin and two set screws are separately packed to prevent damage in transit. Therefore, attach the holder of spool pin in place with a screw driver, as shown in the figure.

- **Fundamentals of Operation**

For Your Safety

1. While in operation, always keep your eyes on the needle, and do not touch any moving parts such as the take-up lever, balance wheel or needle.
2. Always turn off the machine, and unplug from the power supply:
  - \* When making any adjustment in the needle area, such as threading needle, changing needle, or threading bobbin, and the like.
  - \* After using the machine.
  - \* When leaving the machine for any period of time.
  - \* When attaching or removing parts.
  - \* When cleaning the machine.

3. Do not place anything on the foot control, except for your foot.

Before Using the Machine

- Wipe the machine with a clean cloth to remove any dust or oil.
- To replace presser foot or needle follow the guides in the instruction book.
- When setting the machine for sewing, test the stitches on a small piece of the fabric with the threads that will be used for actual sewing.

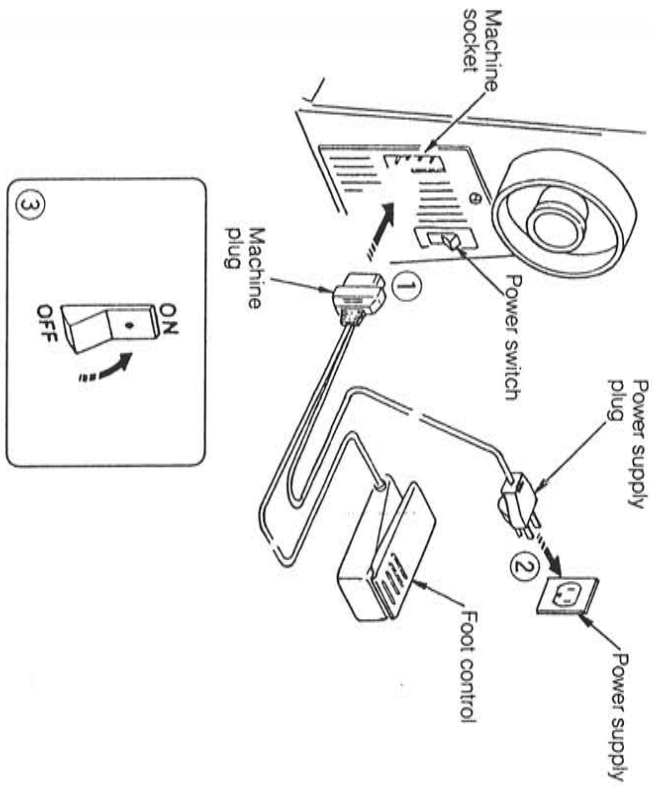
For Longer Life of the Machine

- Do not expose the machine to the sun for long periods of time nor store near a radiator.
- Do not store the machine in an area of high humidity.
- Handle the machine with care to avoid dropping or bumping.



## SECTION II GETTING READY TO SEW

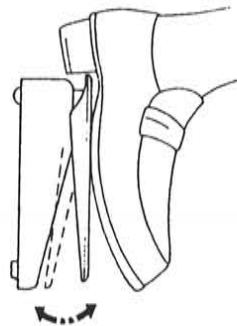
### • Connecting the Machine to the Power Supply



Before connecting the power, make sure the electrical rating (voltage and frequency) of the machine conform to your electrical power.

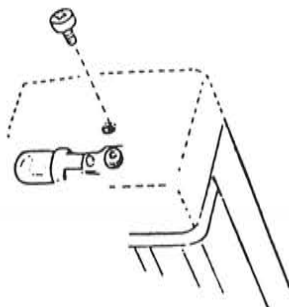
- ① Turn off the power switch, and connect the machine plug to the machine socket.
- ② Connect the power supply plug to your power supply.
- ③ Turn on the power switch.

### • Foot Control



Sewing speed can be varied by the foot control.  
The harder you press on the control, the faster the machine runs.

### • Replacing Sewing Light

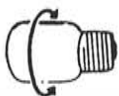


The sewing light is located behind the face plate.  
Unscrew the set screw and remove the face plate.

- To remove . . . Turn it counter-clockwise.
- To replace . . . Turn it clockwise.

#### CAUTION

- \* Before removing the face plate, unplug your machine.
- \* The sewing light may be HOT. Protect your fingers when you handle it.



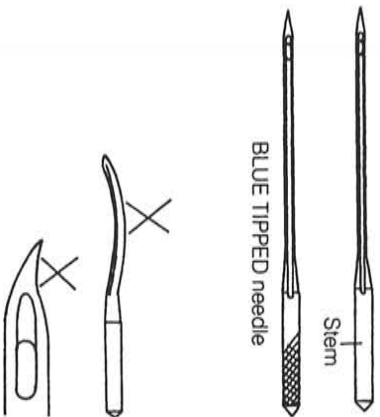
• Thread and Needle Chart

	Fabrics	Threads	Needle Size
Light weight	Crepe de Chine, Voile Lawn, Organdy, Georgette, Tricot	Fine Silk Fine Cotton Fine Synthetic Fine Cotton Covered Polyester	9 or 11
Medium weight	Linens, Cotton, Pique, Serge, Double Knits, Percale	50 silk 50 to 80 Cotton 50 to 60 Synthetic Cotton Covered Polyester	11 or 14
Heavy weight	Denim, Tweed, Gabardine, Coating, Drapery and Upholstery Fabric	50 silk 40 to 50 Cotton 40 to 50 Synthetic Cotton Covered Polyester	14 or 16

- In general, fine thread and needles are used for sewing thin fabrics, and thicker threads and needles are used for sewing heavy fabrics. Always test thread and needle size on a small piece of fabric which will be used for actual sewing.
- Use the same thread for needle and bobbin.

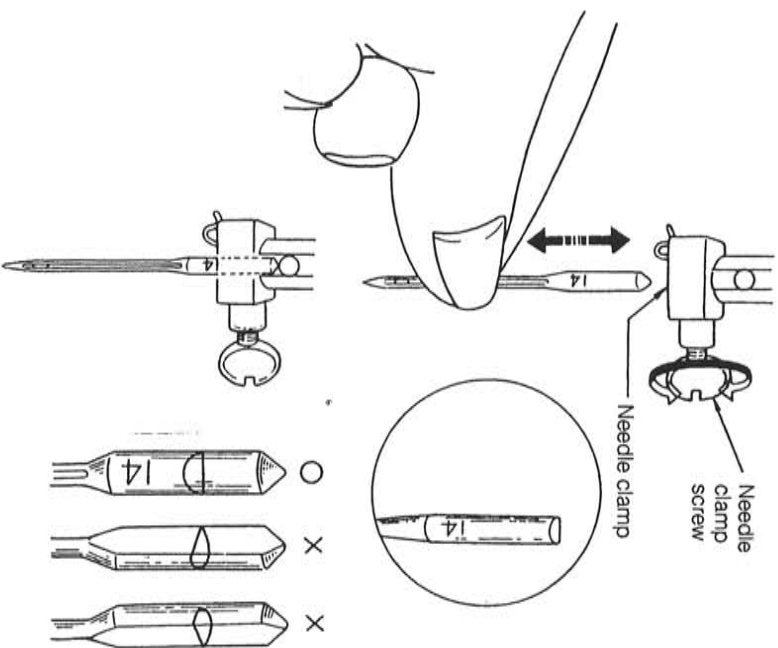
- When sewing stretch, very fine fabric or synthetics, use a BLUE TIPPED needle. The blue tipped needle effectively prevents skipped stitches.
- When sewing very fine fabrics, sew over a piece of paper to prevent yarn distortion.

(To Select a Suitable Needle)



- \* A number indicating the size of needle is marked on the stem.
- \* The higher the number, the thicker the needle.
- \* A BLUE TIPPED needle is supplied with the machine.
- \* Do not use any needle which is bent or blunt.

• Changing Needles



Raise the needle by turning the balance wheel toward you and lower the presser foot.

Loosen the needle clamp screw by turning it toward you.

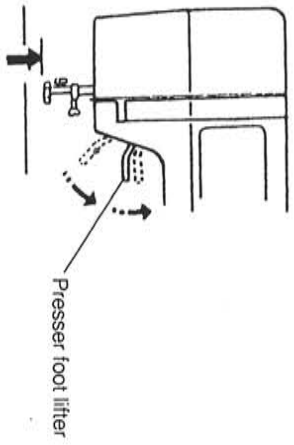
Remove the needle from the clamp.

Insert the new needle into the needle clamp with facing the flat side to the back.

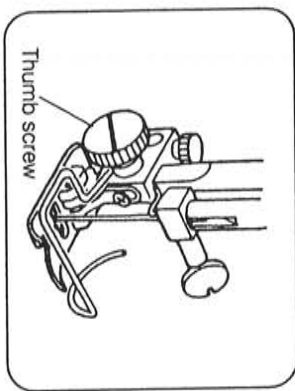
When inserting the needle into the clamp, push it up as far as it will go and tighten the clamp screw firmly with the screwdriver.

• **Raising or Lowering the Presser Foot**

The presser foot lifter raises or lowers your presser foot.

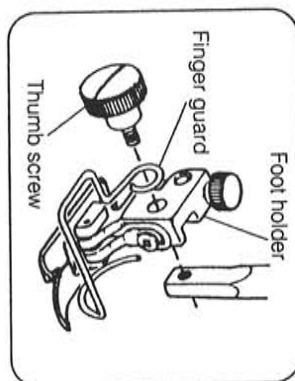


• **To Detach and Attach the Foot Holder, the Finger Guard**



< **To Detach** >

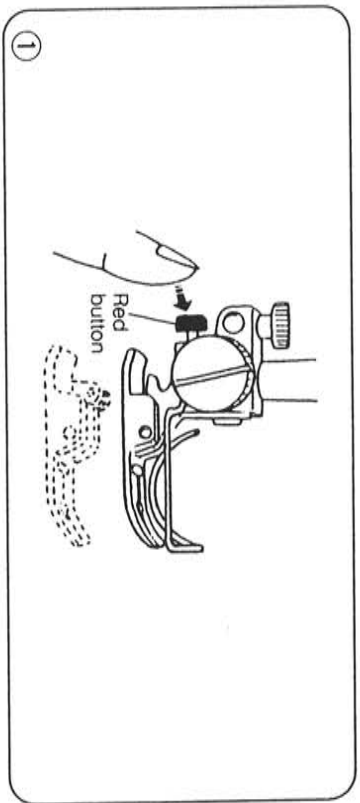
Remove the thumb screw by turning the screw counter clockwise with the screwdriver.



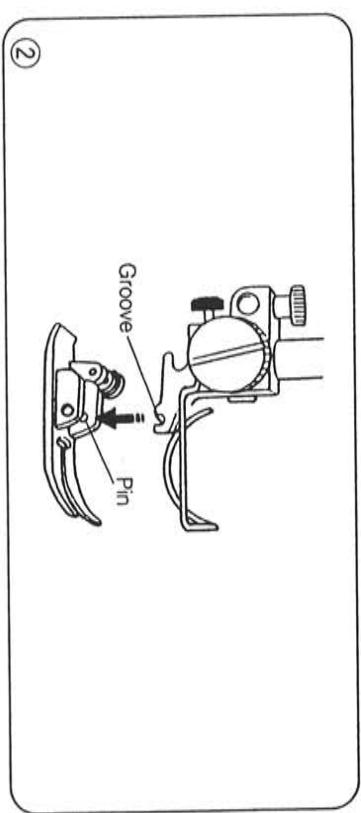
< **To Attach** >

Match the hole in the finger guard and the foot holder with the threaded hole in the presser bar. Fit the thumb screw into the hole. Tighten the screw by turning it clockwise.

• **To Snap the Presser Foot On and Off**

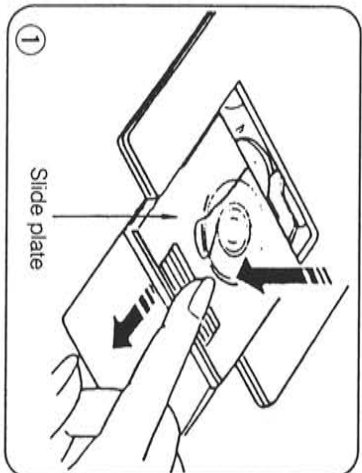


① Press the red button on the back of the foot holder. The presser foot will drop off.

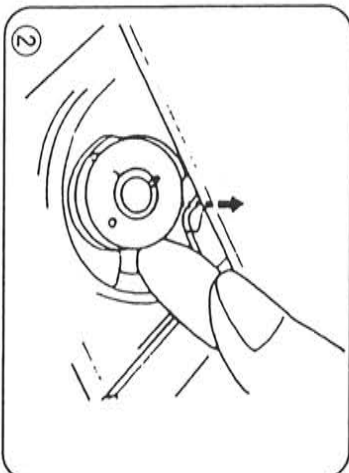


② Place the presser foot so the pin on the foot lies just under the groove of the foot holder. Lower the presser foot lever to lock the foot in place.

### • Removing the Bobbin

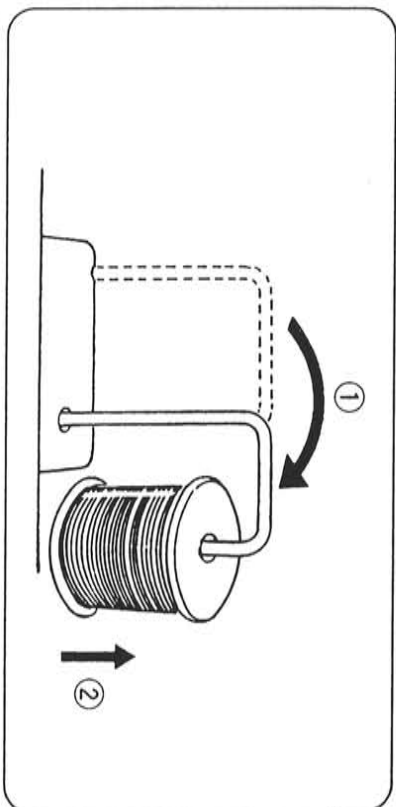


① Gently push slide plate down and slide it towards you.



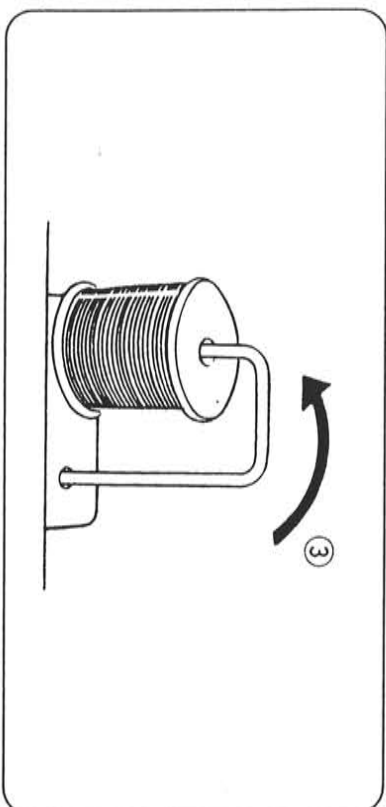
② Lift out the bobbin, as shown.

### • Setting Spool



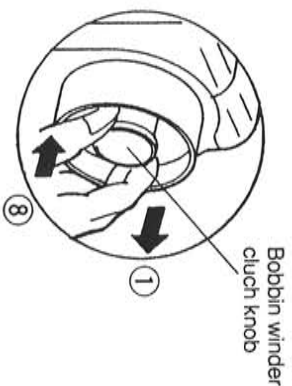
① Turn the spool pin.

② Set the spool from the bottom end of the spool pin as illustrated.



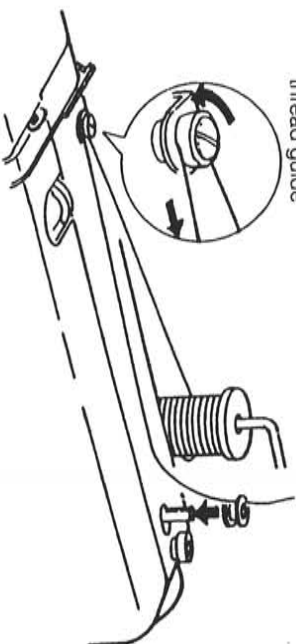
③ Return the spool pin to its original position.

## • Winding the Bobbin

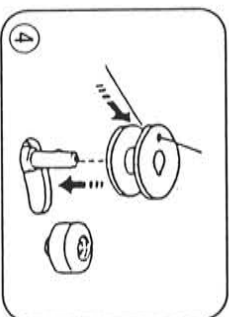


① Pull the clutch knob away from the machine to disengage clutch.

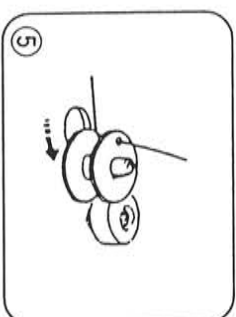
③ Bobbin winder thread guide



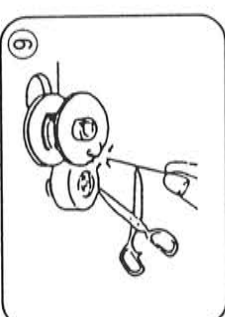
- ② Draw the thread from the spool.
- ③ Guide the thread around the bobbin winder thread guide.



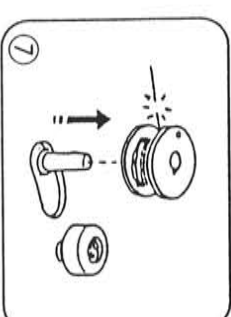
④ Insert the thread through the hole in the bobbin from inside to outside as shown.



⑤ Put the bobbin on the bobbin winder spindle, and push it to the right.



⑥ While holding the free end of the thread with your hand, depress the foot control. Stop the machine when it has made a few turns, and cut the thread close to the hole in the bobbin.

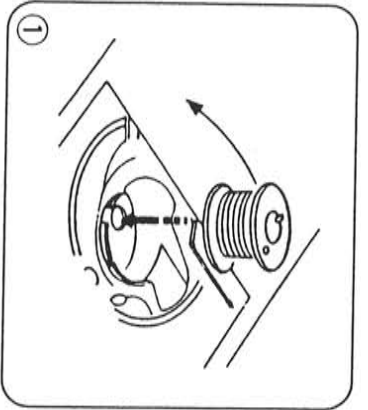


⑦ Depress the foot control again and wind the thread until the bobbin stops. Move the bobbin winder spindle to its original position (left), and cut the thread.

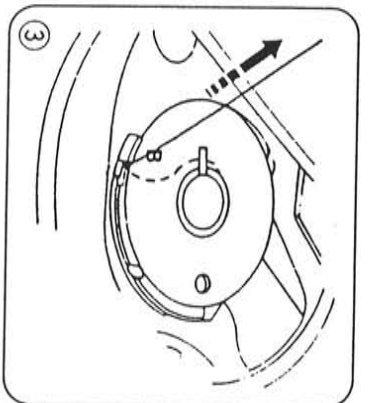
⑧ Push in the clutch knob to engage clutch.

\* The machine will not sew until the clutch knob is pushed in.

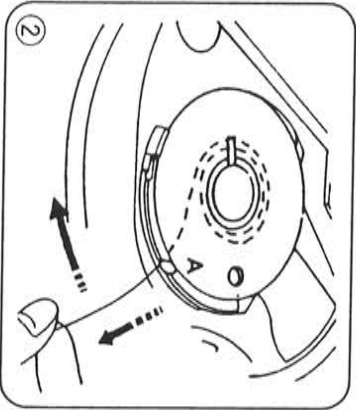
• Inserting the Bobbin



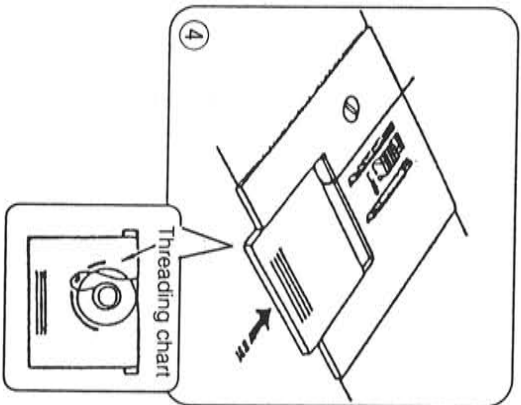
① Place the bobbin in the bobbin holder as the thread end unwinds clockwise.



③ Continue to draw the thread lightly until the thread slips into notch B. Pull out about 15 cm (6") of thread.

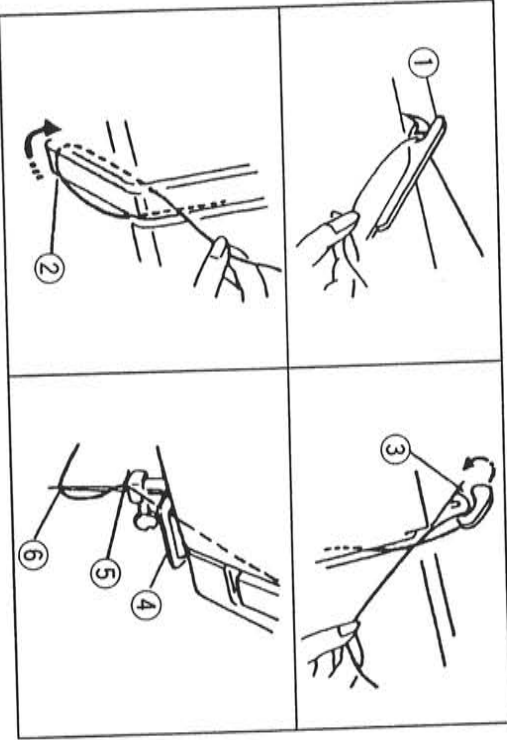
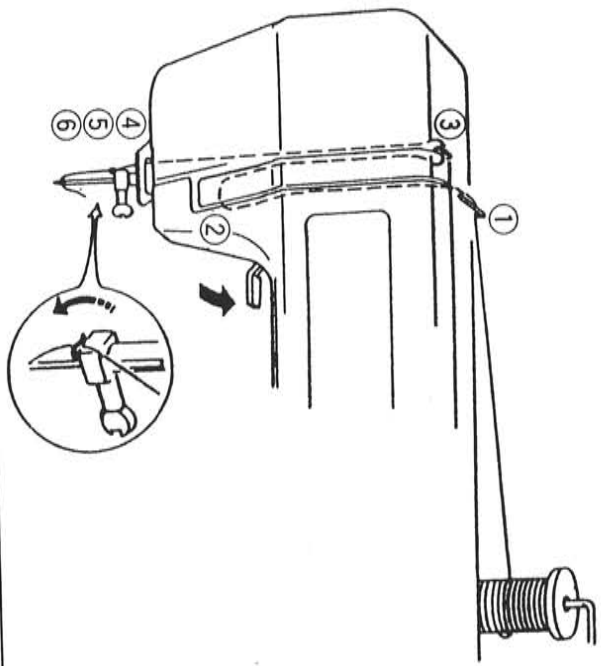


② Guide the thread into the notch A on the front side of the bobbin holder. Draw the thread to the left sliding it between the tension spring blades.



④ Close the slide plate. Check the threading by referring to the chart shown on the slide plate.

• Threading the Machine



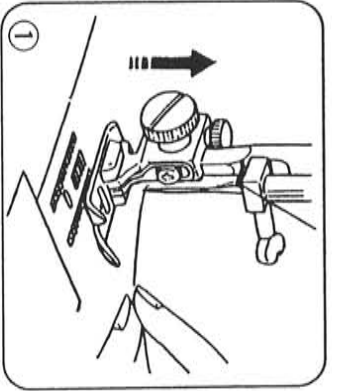
Raise the thread take-up lever to its highest position by turning the balance wheel towards you.  
 Raise the presser foot with the presser foot lifter and pass the thread in the order from ① to ⑥.

- ① Draw thread into thread guide using both hands.
- ② While holding thread near spool, draw thread down into the tension area and then around the check spring holder.
- ③ Firmly draw thread up and through take-up lever from right to left.
- ④ Then draw thread down and slip it into the lower thread guide.
- ⑤ Draw thread down and slip it into needle bar thread guide.
- ⑥ Thread needle eye from front to back.

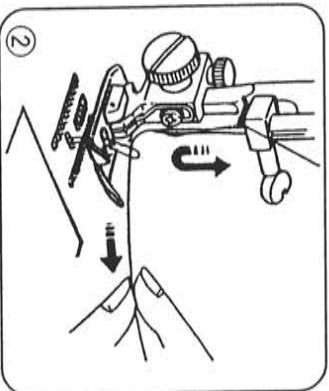
NOTE : You may want to cut the end of thread with sharp scissors for easier needle threading.



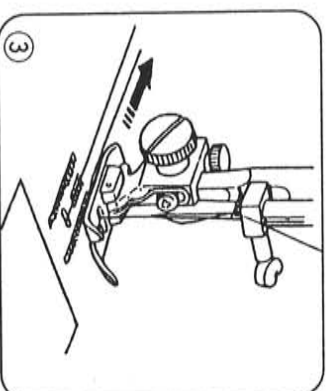
• Drawing Up Bobbin Thread



① Raise the presser foot and hold the needle thread lightly with your left hand.



② Turn the balance wheel slowly towards you with your right hand until the needle goes down and continuously turn the balance wheel until the take-up lever is at its highest position. Lightly draw up the needle thread forming a loop of the bobbin thread.



③ Pull 15 cm (6") of both threads back and under the presser foot.

• Balancing Needle Thread Tension

★ Auto-tension

Set "AUTO" for ordinary sewing to get well-balanced tension.

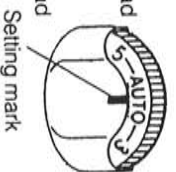


○ For Straight Stitch

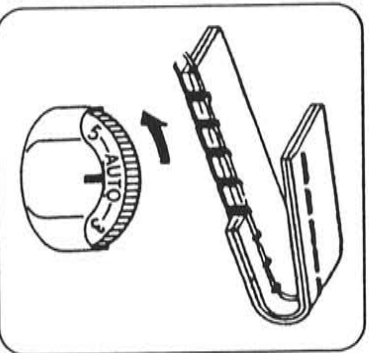
The ideal straight stitch will have threads locked between the two layers of fabric.

○ For Zigzag Stitch

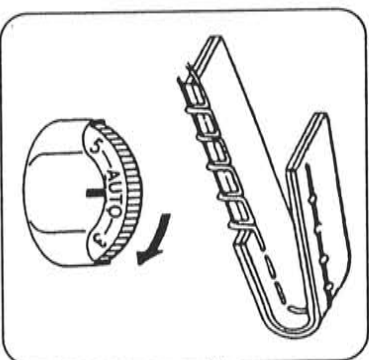
In the correct zigzag stitch, the bobbin threads will not show on the top side of fabric and the top threads will show slightly on the bottom side.



★ Manual Needle Thread Tension

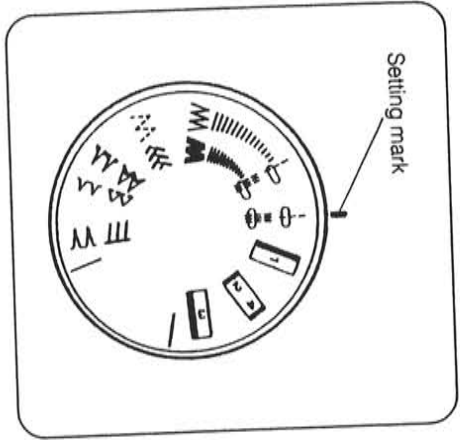


Loosen the needle thread tension by moving the dial to a lower number.



Tighten the needle thread tension by moving the dial to a higher number.

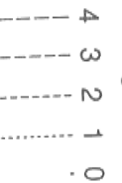
• **Pattern Selector Dial**



Turn the balance wheel with your hand until the tip of needle comes out of fabric. Select the stitch by turning the pattern selector dial.

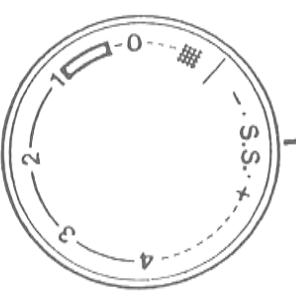
Patterns	Stitch length dial	Stretch stitch patterns	Stitch length dial
1, 2, 3, 4	1~4	0.3~4	0.5~2
	1~4	1~3	2~3
S.S.			

★ **Selecting Stitch Length**



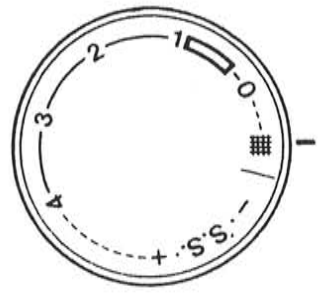
The higher the number, the longer the stitch length. You can select the suitable stitch length for most fabrics.

★ **Selecting Stretch Stitch Patterns**



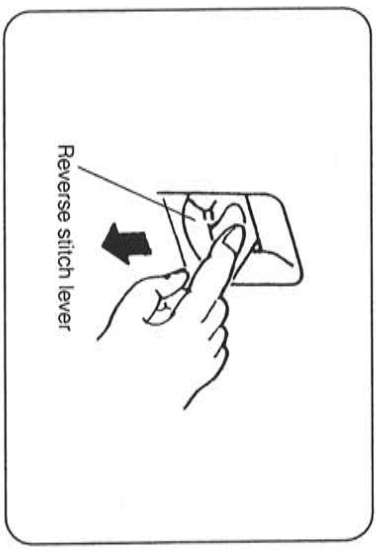
When sewing stretch stitch, set the stitch length dial at "S.S.". When forward and reverse feeds become unbalanced depending upon the type of fabric, correct the balance as follows:  
 When patterns are dense, correct it by turning the dial toward "1".  
 When patterns are coarse, correct it by turning the dial toward "4".

★ Dropping the Feed Dogs



For dropping the feed dogs, turn the stitch length dial to the "# mark.

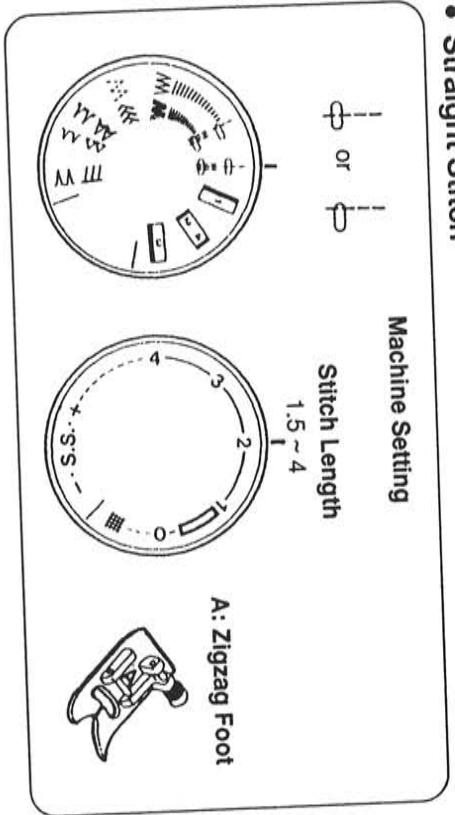
• Reverse Stitch Lever



Fabric is fed in reverse while the lever is pressed. When it is released, fabric is fed forward.

• **Straight Stitch**

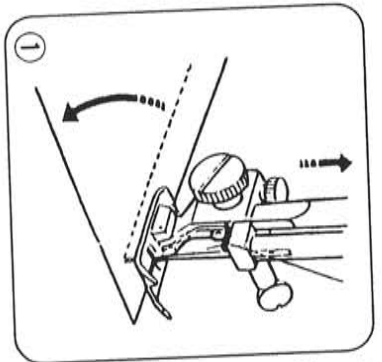
**Machine Setting**



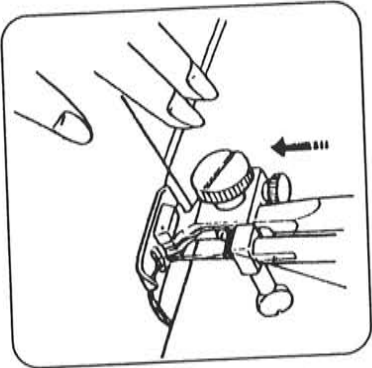
or

**Stitch Length**  
1.5 ~ 4

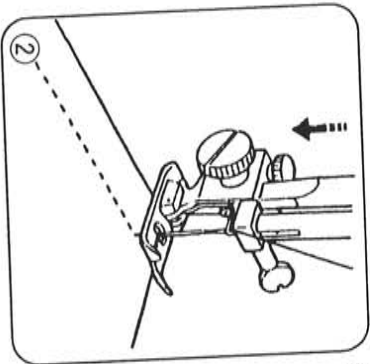
**A: Zigzag Foot**



- 《《 **Changing Sewing Direction** 》》
- ① Bring the needle down into the fabric, and raise the presser foot.

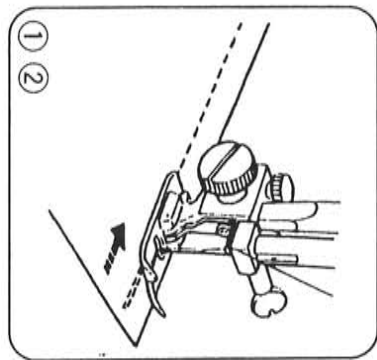


- 《《 **Starting Sewing** 》》
- While holding the threads with your left hand, turn the balance wheel toward you to bring the needle into the fabric where you wish to start sewing.
- Lower the presser foot, and press the foot control gently, then start sewing slowly.



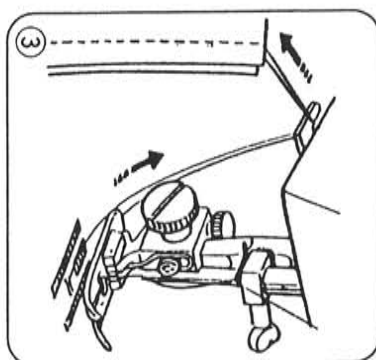
- ② Then pivot the fabric to the direction desired. Lower the foot to start sewing.

• Zigzag Stitch




- ① For fastening the end of seams, press the reverse stitch lever and sew several reverse stitches.
- ② Bring the thread take-up lever at its highest position, and raise the presser foot. Then draw the fabric out to the rear.

《Fastening Seams》





- ③ Cut the threads with leaving proper length of their ends for starting the next seam.




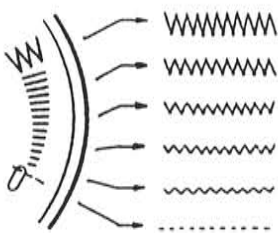
Machine Setting

Stitch Length  
0.3 ~ 4

A: Zigzag Foot




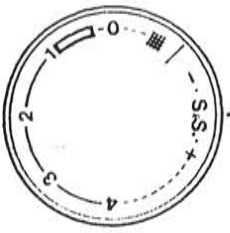


Zigzag width can be regulated in the range of the symbol as illustrated left.


• Overcasting

**Machine Setting**

**Stitch Length**


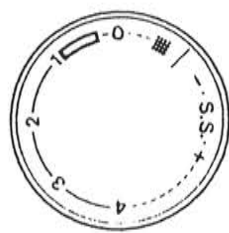
**C: Overedge Foot**




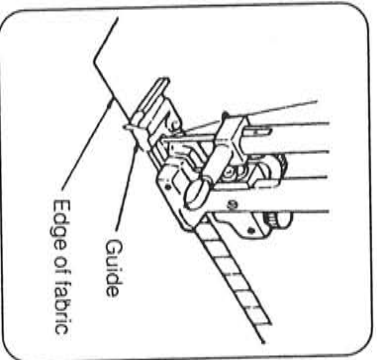
• Triple Strength Stitch

**Machine Setting**

**Stitch Length**

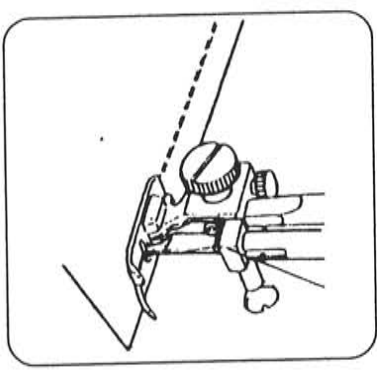
**A: Zigzag Foot**

Here's How

Place the fabric under the presser foot so that the stitches are made over the edge.

**NOTE:** When using stretch knit fabric, use a blue stretch fabric needle which effectively prevents skipped stitches.



This seam is formed with two stitches forward and one stitch backward. Since the seam can not be ripped off easily, the garments should be basted for fitting before seaming.

• Blind Hemming

**Machine Setting**

Stitch Length  
1~3

**G: Blind Stitch Foot**

**How to Fold the Fabric**

Light weight fabric

Wrong side of fabric

0.4 to 0.7 cm  
(5/32 to 9/32")

Heavy weight fabric

Wrong side of fabric

0.4 to 0.7 cm  
(5/32 to 9/32")

On heavy weight fabrics that ravel, the raw edge should be over-cast first. On light weight fabrics the raw edge can be turned under and pressed.

Fold up the hem the desired amount and pin in place. Fold the hem under the fabric as illustrated.

**How to Sew**

①

When the needle comes to the left

When the needle comes to the right

②

Sliding guide

Guide screw

① Position the fabric on the machine so that the needle just pierces the folded edge of the fabric when the needle comes over to the extreme left side. Lower the presser foot.

② Turn the guide screw and move the sliding guide against the folded edge. Sew the folded edge guiding along the sliding guide.

**How to Set the Guide**

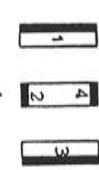
Needle

Guide screw

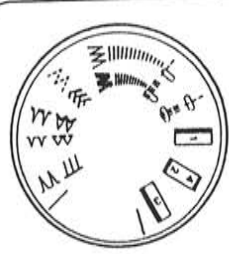
Sliding guide

• Buttonhole

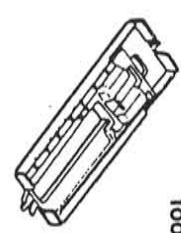
**Machine Setting**




**Stitch Length**  
red zone  
(0.3 ~ 1)



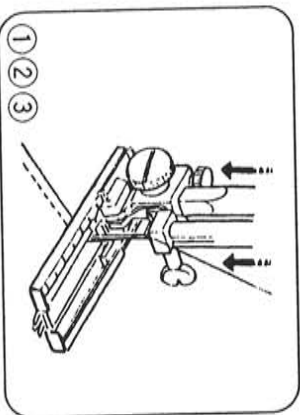
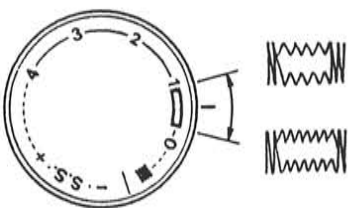
**J: Sliding buttonhole foot**



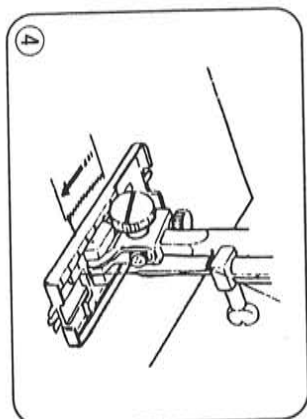
Always make a practice buttonhole on a scrap of fabric you plan to use. Try the buttonhole with the button you will use.

The symbol  (red zone) on the stitch length dial indicates the range of adjustment for buttonhole.

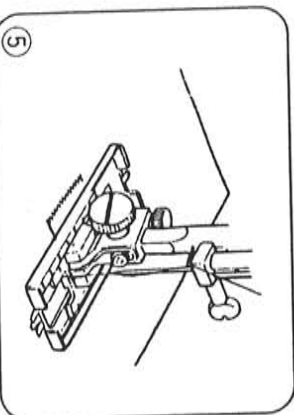
If you want the coarse stitches of the buttonhole, turn the dial toward "1" direction. If you want the dense stitches of the buttonhole, turn the dial toward "0" direction.



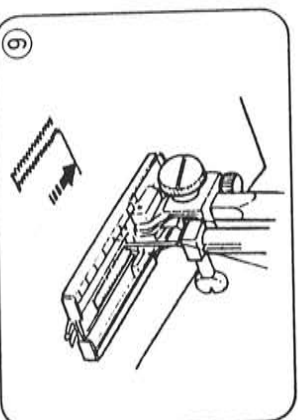
- ① Set the pattern selector dial at "1".
- ② Lead both threads to the left.



- ④ Sew down the left side of the buttonhole to the bottom end. Raise the needle.



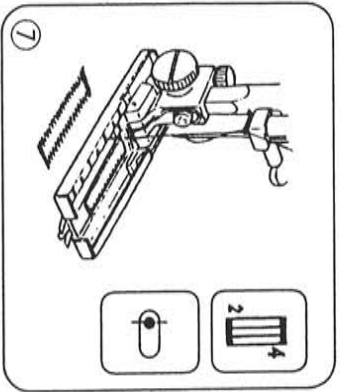
- ⑤ Set the pattern selector dial at "2", and sew 5 stitches of bartack, then raise the needle from the fabric.



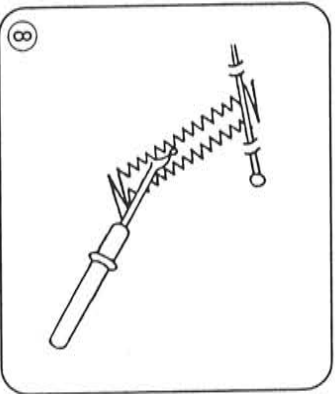
- ⑥ Set the pattern selector dial at "3". Sew up the right side of the buttonhole. Stop the machine when you are directly opposite the first stitch on the left hand side, and raise the needle.



• **Tricot Stitch**



⑦ Set the pattern selector dial at "2" and raise the needle from the fabric. Then set the pattern selector dial at "4" and sew a few stitches to secure the seam.

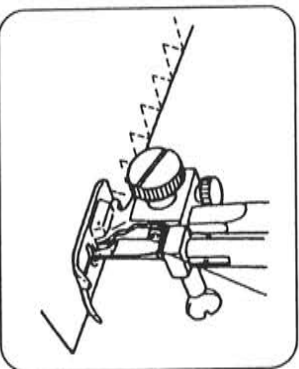


⑧ Remove the fabric from the machine, and cut the sewing threads. Pierce a pin inside the bartack. Then cut the opening with a seam ripper. Be careful not to cut the stitches.

**Machine Setting**

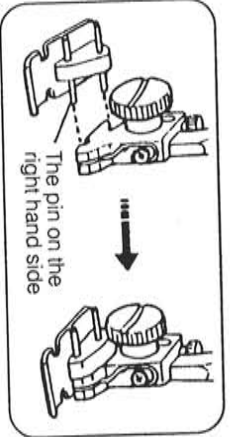
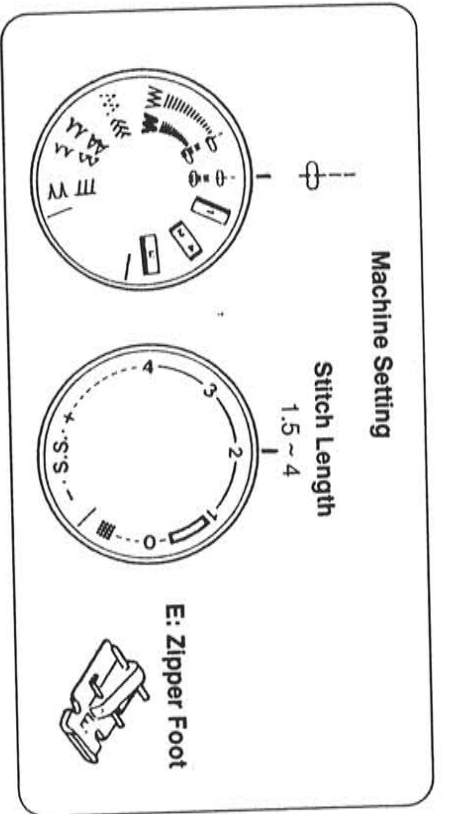
**Stitch Length**  
0.5 ~ 2

**A: Zigzag Foot**

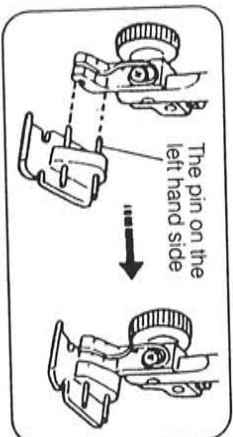


The tricot stitch is used to finish seam allowance on synthetics and other fabrics that tend to pucker. The stitch is excellent for darning and mending tears in fabric as well.

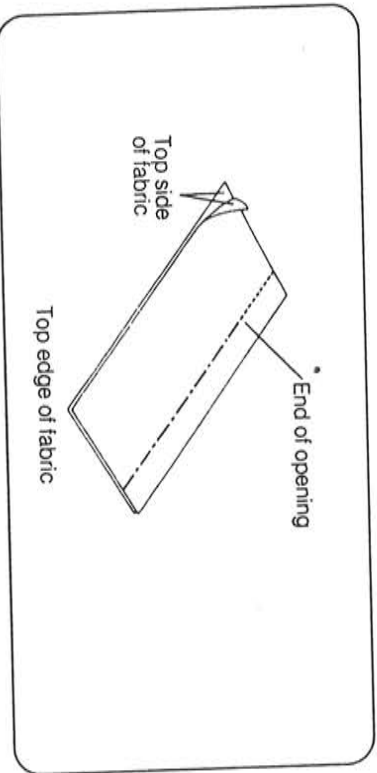
## • Zipper Application



- To attach the zipper foot:
- To sew on the left side of the zipper, attach the presser bar to the right pins on the zipper foot.



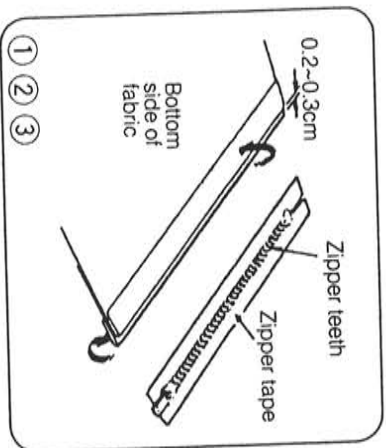
- To sew on the right side of the zipper, attach the presser bar to the left pins on the zipper foot.



### Fabric Preparation:

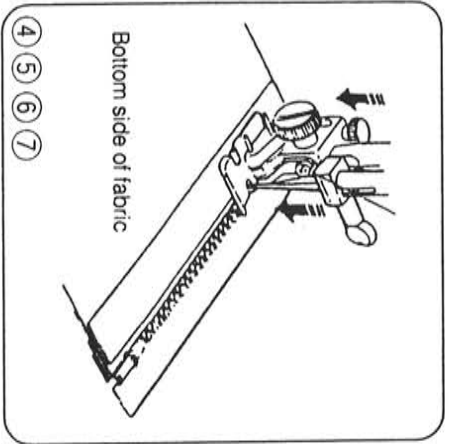
Put the top sides of the fabric together and sew to the end of the zipper opening. Use the reverse to lock the stitches.

Baste the zipper opening with stitch length at "4" and top thread tension at "3".

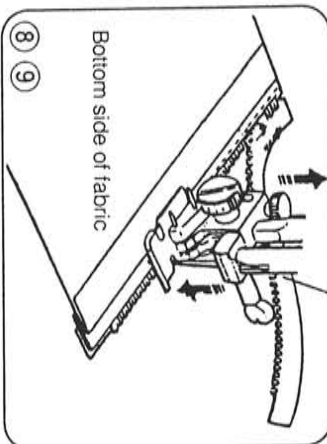


### To Sew:

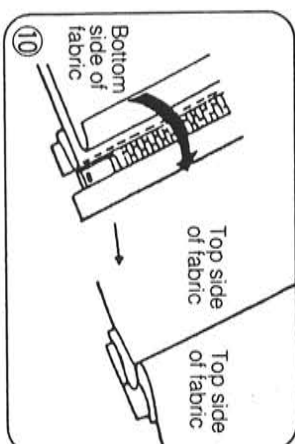
- ① Reset stitch length at 2 and top thread tension at 2 to 6. Fold back the left seam allowance as shown.
- ② Turn under the right seam allowance to form a 0.2 to 0.3 cm fold.
- ③ Place the zipper teeth next to the 0.2 to 0.3 cm fold and pin in place.



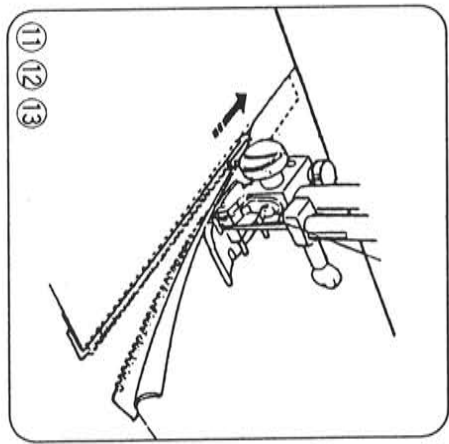
- ④ Attach the presser bar to the right pins on the zipper foot.
- ⑤ Lower the zipper foot on the top side at the bottom of the zipper so that the needle pierces the fold and the zipper tape.
- ⑥ Sew through the fold and the zipper tape to the point where the slider begins.
- ⑦ Lower the needle to hold the fabric and raise the presser foot.



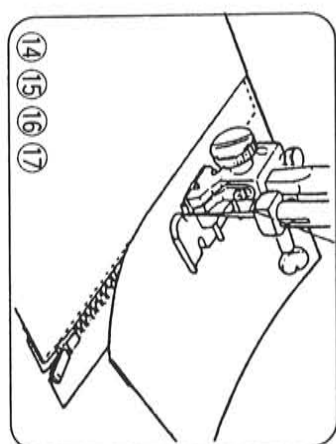
- ⑧ Open the zipper.
- ⑨ Lower the presser foot and stitch the rest of the seam.



- ⑩ Close the zipper and turn the fabric top side up.



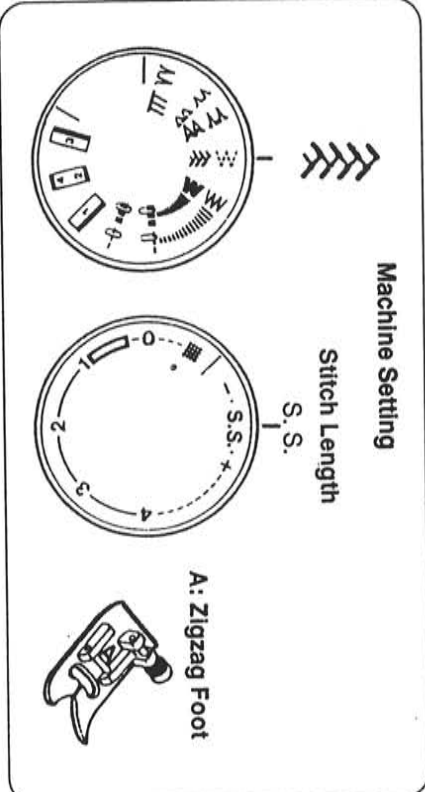
- ⑪ Remove the zipper foot and attach the presser bar to the left pins on the zipper foot.
- ⑫ Stitch across and below the bottom of the Zipper.
- ⑬ Turn the corner and continue to guide the foot along the zipper teeth, as shown. Stitch through the fabric and zipper tape.



- ⑭ Stop about 5 cm from the top of the zipper.
- ⑮ Lower the needle into the fabric and raise the presser foot.
- ⑯ Remove the basting stitches and open the zipper.
- ⑰ Lower the foot and stitch the rest of the seam. Make sure the fold is even.

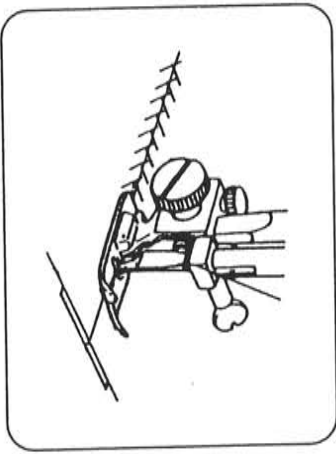
• Feather Stitch

**Machine Setting**



Stitch Length  
S.S.

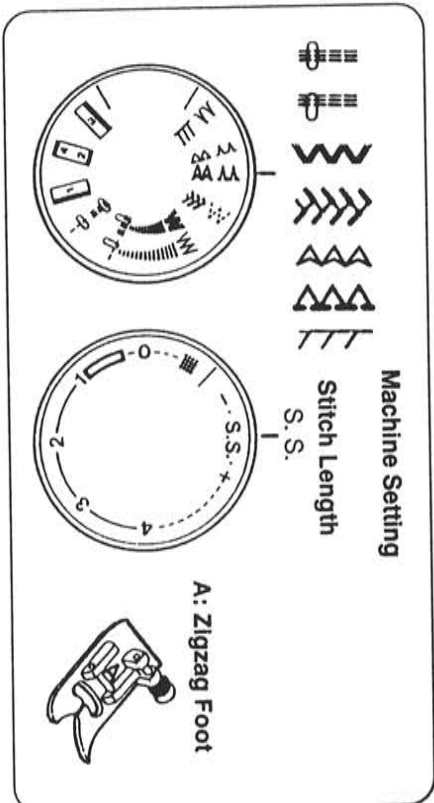
A: Zigzag Foot



Butt two folded edges together and use this stitch to join them.

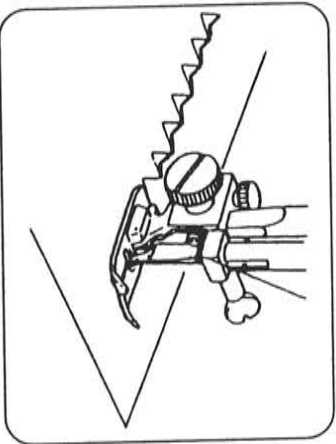
• Stretch Stitch Patterns

**Machine Setting**



Stitch Length  
S.S.

A: Zigzag Foot

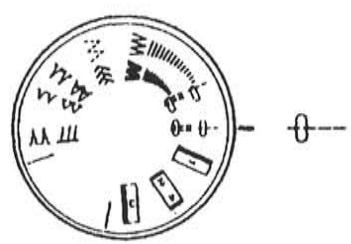


When forward and reverse feeds become unbalanced depending upon the type of fabric, correct the balance by turning the stitch length dial as follows:

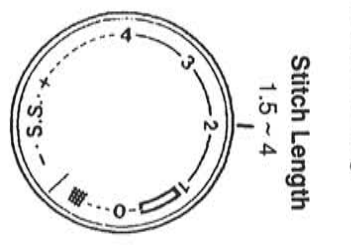
When patterns are compressed, correct it by turning the dial toward  
 + + +  
 When patterns are drawn out, correct it by turning the dial toward  
 - - -

• Rolled Hem


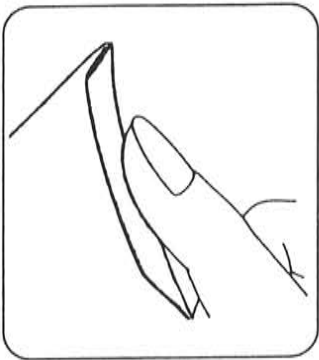
**Machine Setting**



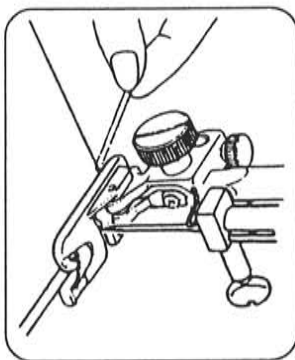
**Stitch Length**  
1.5 ~ 4



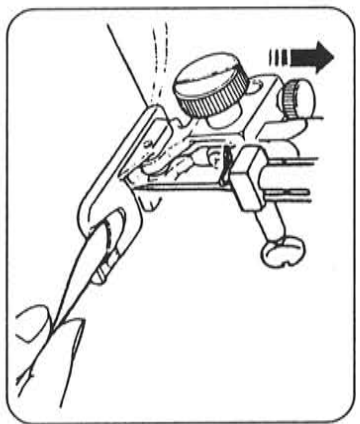
**D: Hemmer Foot**

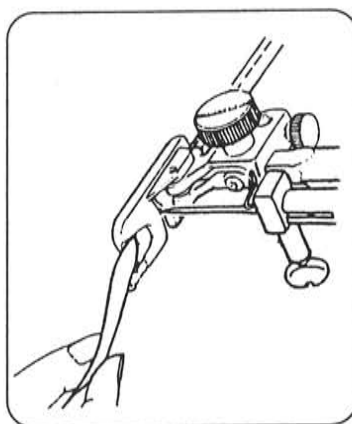
Make a double 0.25 cm (1/8") fold approximately 8 cm (3") in length.



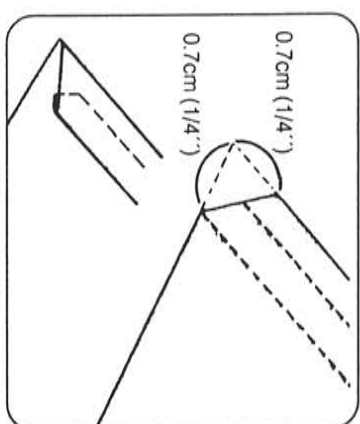
Lower the needle into the fabric at the point where sewing is to begin, then lower the hemmer foot. Sew 3 or 4 stitches while holding the needle and bobbin threads.



Lower the needle into the fabric and lift the hemmer foot. Insert the folded portion of the fabric into the curl of the hemmer foot.



Lower the hemmer foot, then sew by lifting up the edge of the fabric to keep it feeding smoothly and evenly.



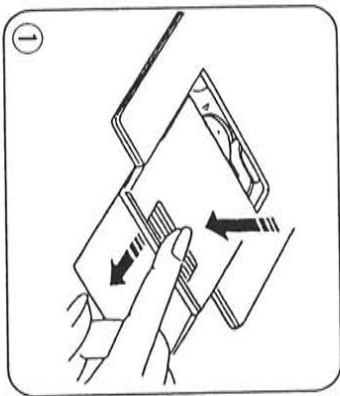
Trim about 0.7 cm (1/4") from corners as illustrated, to reduce bulk.

## SECTION IV CARING FOR YOUR MACHINE

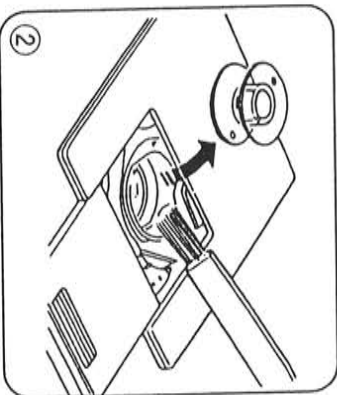
\* Before cleaning, unplug your machine and raise the needle.

### • Cleaning the Bobbin Holder

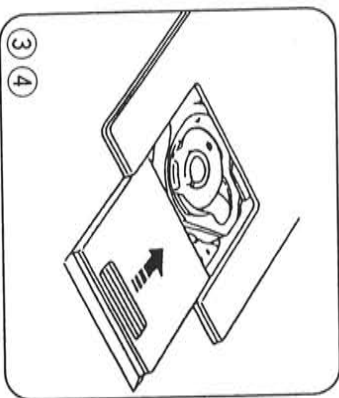
- ① While pushing the front end of slide plate, slide it toward you as far as it will go.



- ② Take out the bobbin, and remove lint with lint brush. You may use vacuum cleaner.

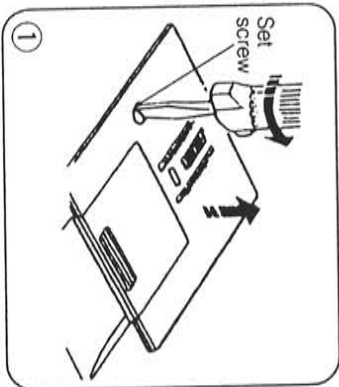


- ③ Insert the bobbin.
- ④ Close the slide plate.

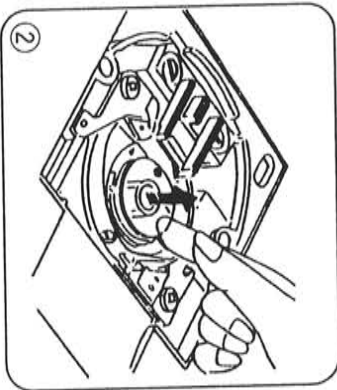


### • Cleaning the Hook Race and Feed Dog

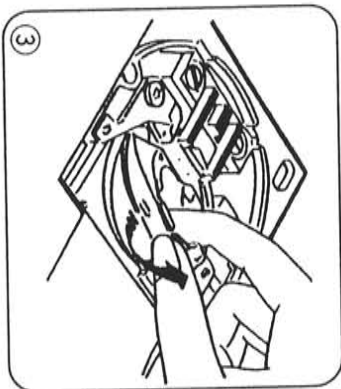
- ① Remove the needle and presser foot. Remove the needle plate by unscrewing its set screw with a screw driver.

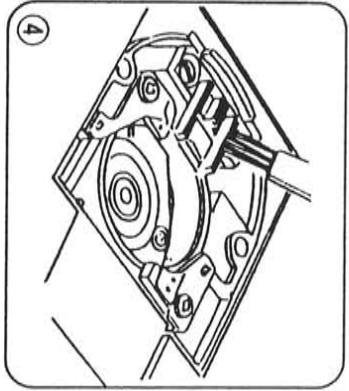


- ② Take out the bobbin.

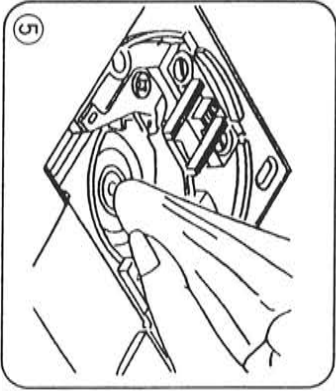


- ③ Lift up the front end of bobbin holder to remove it.

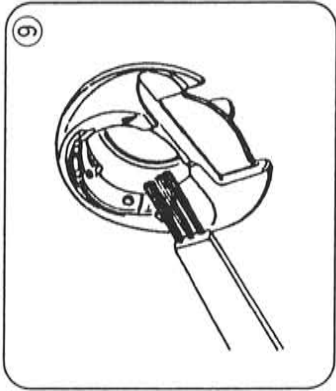




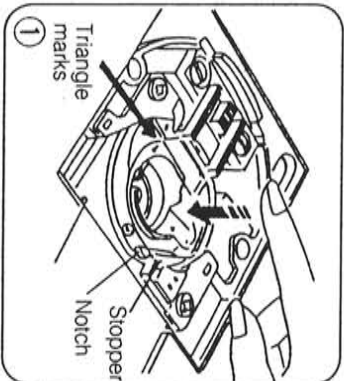
④ Brush off the lint on the feed dog.



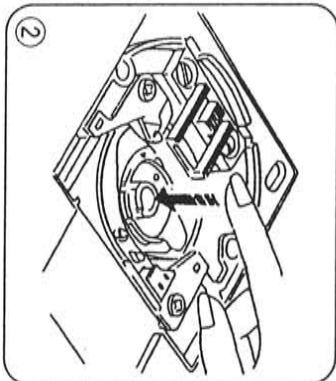
⑤ Wipe the hook race with a soft dry cloth.



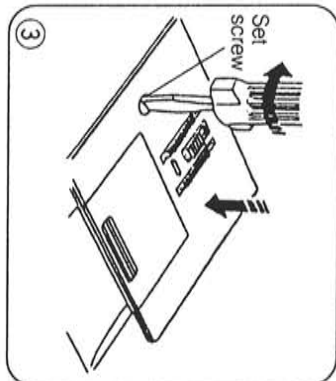
⑥ Clean the bobbin holder with a lint brush and a soft dry cloth.



① Line up the triangle marks and position the bobbin holder so that the notch fits next to the stopper in the hook race.



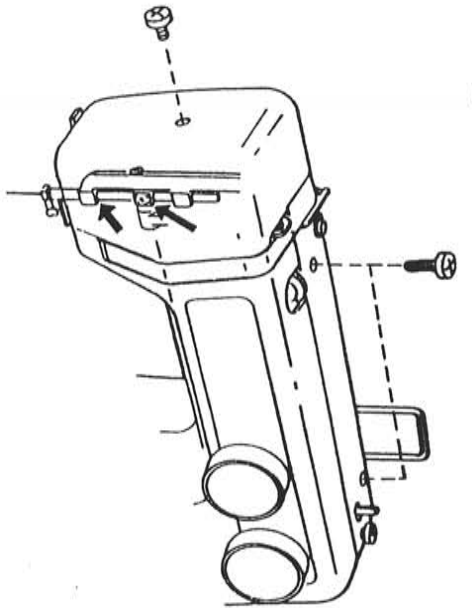
② Put the bobbin in.



③ Attach the needle plate with set screw. Insert the needle, and attach the presser foot.

**Resetting the Bobbin Holder and Needle Plate**

• Oiling the Machine



**Unscrew and remove the face plate.**

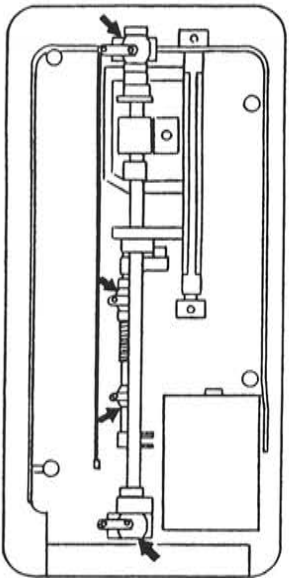
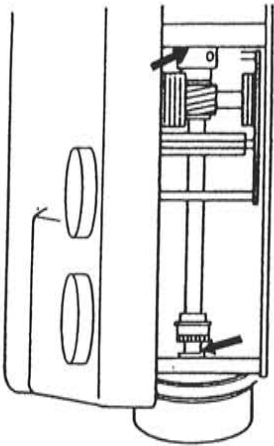
Apply a few drops of fine quality sewing machine oil to the points indicated by the arrows in the figures.

For a machine in constant use, oil two or three times a year.

In case the machine does not work smoothly due to standing idle for some time, apply a few drops of kerosene at the oiling points, and run the machine rapidly for a minute.

Before oiling, wipe off the oiling points.

Remove the two screws and take off the top cover. Apply a few drops of fine quality sewing machine oil to the points indicated by the arrows in the figures.





• Trouble Shooting

Condition	Cause	Reference
The machine does not run smoothly and is noisy.	<ol style="list-style-type: none"> <li>1. Threads have been caught in hook mechanism.</li> <li>2. The feed dog is packed with lint.</li> </ol>	See Pages 26 ~ 27
The needle thread breaks.	<ol style="list-style-type: none"> <li>1. The needle thread is not threaded properly.</li> <li>2. The needle thread tension is too tight.</li> <li>3. The needle is bent or blunt.</li> <li>4. The needle is incorrectly inserted.</li> <li>5. The fabric is not being drawn to the back when sewing is finished.</li> <li>6. The thread is either too heavy or too fine for the needle.</li> </ol>	See Page 12 See Page 13 See Page 6 See Page 7 See Page 17 See Page 6
The bobbin thread breaks.	<ol style="list-style-type: none"> <li>1. The bobbin thread is not threaded properly in the bobbin holder.</li> <li>2. Lint has been collected in the bobbin holder and/or tension spring.</li> <li>3. The bobbin does not rotate smoothly.</li> </ol>	See Page 11 See Pages 26 ~ 27 Replace the bobbin.
The needle breaks.	<ol style="list-style-type: none"> <li>1. The needle is incorrectly inserted.</li> <li>2. The needle is bent or blunt.</li> <li>3. The needle clamp screw is loose.</li> <li>4. The tension of the needle thread is too tight.</li> <li>5. The fabric is not drawn to the back when sewing is finished.</li> <li>6. The needle is too fine for the fabric being sewn.</li> <li>7. The pattern selector dial had been turned while the needle was in the material.</li> </ol>	See Page 7 See Page 7 See Page 7 See Page 13 See Page 17 See Page 6 See Page 14
Skipped stitches	<ol style="list-style-type: none"> <li>1. The needle is incorrectly inserted.</li> <li>2. The needle is bent or blunt.</li> <li>3. The needle and/or threads are not suitable for the work being sewn.</li> <li>4. A BLUE TIPPED needle is not being used for sewing stretch, very fine fabrics and synthetics.</li> <li>5. The needle thread is not threaded properly.</li> </ol>	See Page 7 See Page 6 See Page 6 See Page 6 See Page 12

Condition	Cause	Reference
Seam Puckering	<ol style="list-style-type: none"> <li>1. The needle thread tension is too tight.</li> <li>2. The needle thread and/or bobbin thread are not threaded properly.</li> <li>3. The needle is too heavy for the cloth being sewn.</li> <li>4. The stitches are too coarse for the fabric being sewn.</li> </ol> <p>* When sewing extremely light weight materials, place a sheet of paper underneath the fabric.</p>	<p>See Page 13 See Pages 11 ~ 12 See Page 6 See Page 14</p>
Stitches form loops below the work.	<ol style="list-style-type: none"> <li>1. The needle thread tension is too loose.</li> <li>2. The needle is either too heavy or too fine for the thread.</li> </ol>	<p>See Page 13 See Page 6</p>
The cloth is not feeding smoothly .	<ol style="list-style-type: none"> <li>1. The feed dog is packed with lint.</li> <li>2. The stitches are too fine.</li> <li>3. The feed dog is not raised after "Drop feed " has been used.</li> </ol>	<p>See Pages 26 ~ 27 See Page 14 See Page 15</p>
The machine does not work.	<ol style="list-style-type: none"> <li>1. The machine is not plugged in.</li> <li>2. A thread is caught in the hook race.</li> <li>3. Bobbin winder clutch knob is not pushed in.</li> </ol>	<p>See Page 5 See Pages 26 ~ 27 See Page 10</p>
The buttonhole stitches are not balanced.	<ol style="list-style-type: none"> <li>1. The stitch length is not suitable for the fabric being sewn.</li> <li>2. The work is being pulled or held back.</li> </ol>	<p>See Page 14 Do not force the fabric for guiding.</p>
The machine is noisy.	<ol style="list-style-type: none"> <li>1. The machine is in need of oil.</li> <li>2. Dust and lint have collected in the hook mechanism.</li> <li>3. The feed dog is packed with lint.</li> </ol>	<p>See Page 28 See Pages 26 ~ 27 See Pages 26 ~ 27</p>