



# Janome LOFT 100 New Owner Lesson

## Ordinary Sewing Session:

- LOFT 100 Sewing Machine
- Power cord and foot control
- All the accessories that were packed with the machine

## Fabric:

- Several 6" squares of cotton
- Two 2" squares of cotton for appliqué
- Several 6" squares of tear away stabilizer
- Several 6" squares of batting
- 3/8"-1/2" button
- All-purpose sewing thread

## Getting Ready to Sew

- Attach foot control.
- Turn on machine.
- Wind a bobbin; refer to page 15 of instruction book.
- Thread machine; refer to pages 16 and 17 of instruction book

**Tip:** When following the thread path for the needle, hold the thread taut with two hands so that it seats properly in tension and take up lever.

## The Basics

1. When machine is first turned on, it will automatically be at stitch #00 Straight Stitch. width and length are displayed on right side of touch screen.



2. Fold a 6" square in half place under presser foot lining up folded edge with 5/8" guide on needle plate.

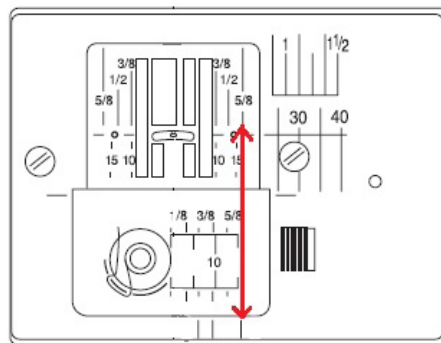

3. Sew a seam pressing and holding the reverse button for about 4 stitches at beginning and end of seam.
4. Press the Mode button to move the cursors under the numbers on the screen.
5. Move the cursor under the Width.



6. Change the needle position by pressing the - button. The needle will move in increments of .5mm. Set the needle at 2.0mm.
7. Place the folded square under the presser foot lining up the folded edge with 5/8" guide, sew a seam, reversing at the beginning and end of the seam.
8. Move the cursor under the stitch pattern number. Press the + button to select stitch #06.
9. Sew a zigzag stitch. The stitch automatically made a four-stitch lock at beginning. Press locking stitch button at the end. Machine will lock and stop.





# Janome LOFT 100 New Owner Lesson



10. Change width to 5.0mm, length 0.8mm. Sew another line of zigzag stitch.

**Note:** The “M” and “R” notes on stitches 06 and 07 indicate the position of the base line of the stitch.

 M The base line is center, the width changes equally on both sides.



 R The base line is right, the width changes on left side only

11. Select Stitch #01. 
12. Place fabric under presser foot, start sewing. The machine will automatically reverse at beginning.
13. Press Reverse button at end, but do not hold. The machine will sew in reverse 4 stitches, come forward and stop.
14. Select Stitch #02. 
15. Place fabric under presser foot, start sewing. The machine will automatically lock off at beginning.
16. Press Reverse button at end, but do not hold. The machine will lock off and stop.
17. Select Stitch #00.
18. Disconnect Foot control.
19. Place fabric under presser foot. Press and hold Start/Stop. The machine will start sewing slowly. Release the button and the machine will speed up. 
20. Press and hold Start/Stop ½” from end of fabric. The machine will slow down, release button at end and machine will stop.

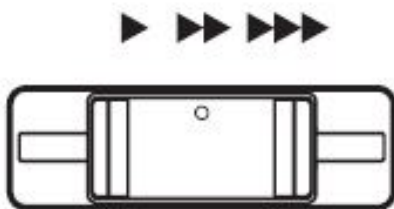
**Note:** Use the Speed Controller to set the machine for the speed you are most comfortable with.



## Decorative Stitches

1. Select Stitch #78. 
2. Attach Satin Stitch foot F.
3. Place 6” square of cotton with stabilizer under presser foot.
4. Sew a line of stitches, press the Locking Stitch button ½” before the end. The machine will complete the stitch pattern.
5. Sew another line of decorative stitches, press the Reverse button ½” before the end. The machine will lock off immediately.
6. Select Stitch #28. 
7. Place 2” appliqué square on stabilized 6” square. Line up right edge of appliqué with needle. Sew to corner.
8. Use Up/Down button to lower needle. 
9. Lift presser foot and pivot. Continue sewing around appliqué pivoting at each corner and pressing Reverse button at end to lock off.

# Janome LOFT 100 New Owner Lesson



## Free Motion Quilting

1. Attach the Satin Stitch F Foot
2. Drop Feed Dogs.

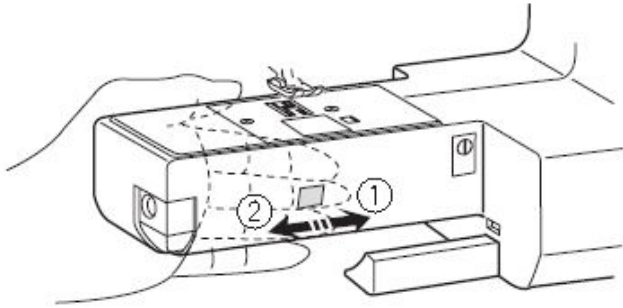

### Note:

- Push lever on back of free arm to the right (① on figure) to lower.
- Push lever to left (② on figure) to raise. The feed dogs will come up with the first stitch.
- Make sure presser foot is up when lowering and raising feed dogs.

3. Set speed control at medium.
4. Place quilt sandwich under presser foot, lower presser foot.
5. Push Up/Down button two times, pull bobbin thread to the top for a clean back.
6. Start sewing, moving the fabric under the presser foot at an even speed.
7. Raise Feed Dogs when free motion quilting is complete.

Note: Free motion quilting is a combination of speed of needle and speed the fabric is moved.

Practice is the only way to achieve the best results.

## Buttonholes

1. Select Stitch #18.
2. Place button in back of buttonhole foot, attach foot, then pull down buttonhole lever.

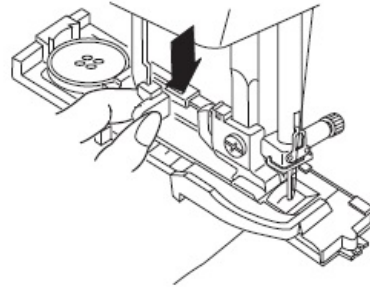

3. Place fabric with stabilizer under presser foot, lining up front edge of fabric with 5/8" guide on needle plate.

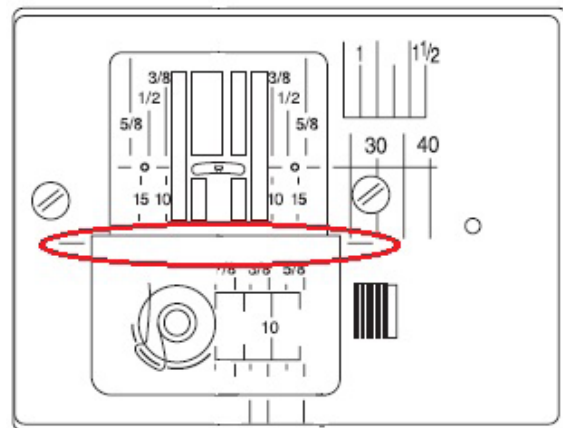

4. Start the machine. The machine will automatically stop when the buttonhole is completed.