

Mini Wool and Leather Tote

Created by: Rachel Barnes, Janome Maker



The mini wool and leather tote project was inspired by the Tiny Bag pattern by sewcanshe.com. This cute little tote bag is small handy to use. Substituting wool and leather details helps elevate the finished pouch and be sewn with a standard Janome sewing machine. This project omits the lining for a quick project. This would be a special gift to share or one to enjoy making for yourself.

Time: 4 - 6 hours

Skill Level: Intermediate

Janome Supplies Required:

- Sewing machine needles (matching selected fabric)
- Standard sewing machine (sample was made with the Skyline S7)
- Zipper foot E (or AcuFeed Flex Zipper foot)
- Even Feed foot or AcuFeed Flex foot AD if applicable

Fabric and Notions Required:

- Inspired by this project tutorial, instructions are modified for this project
- 12", 44" wide fabric / Medium weight Wool or Mid-weight Denim
- 2 pieces of 2mm leather 1" x 11"
- Matching and contrasting thread
- Iron/Tailor's clapper or hardwood sample/ Sleeve board
- 2 ½" Ominigrid square ruler
- Rotary cutter/ruler/mat

- 9" zipper
- Sewing pins/fabric clips
- Hand sewing needle

Sample Notes:

- Fabric: 100% wool, medium-weight, light grey
- 90/14 Leather needle
- Grey thread, Guttermann
- Brown thread, Coats All purpose thread, Color 7060
- Zipper: Coats, Jim Holtz Eclectic Elements 9", orange, color 7820

Machine Preparation Tips:

Prior to sewing, use scraps of the selected fabric with contrasting threads to adjust and set the stitch tensions on the sewing machine.



Mini Wool and Leather Tote

Sewing Instructions:

A dual feed or walking foot is utilized for the majority of this project. The sample uses a mid-weight wool. It has a nap so the dual feed foot offers a nice finish to the seam without compressing the texture of the fabric.

THE FOLLOWING FABRIC DIMENSIONS ARE USED FOR THIS PROJECT:

- 2 pieces of wool fabric (outer bag), 7" x 9"
- 1 piece of wool fabric (outer pocket), 11" x 9"
- 2 pieces of leather (handles), 1" x 11"

OUTER POCKET:

1. Fold the wool pocket piece in half (with the wrong sides facing, the 9" edges together).
2. Iron the fold with a wool/steam setting. Use the Tailor's clapper immediately after ironing the fold. Utilizing the Tailor's clapper elevates the finishing details when sewing with wool or denim. If a Tailor's clapper is not available, I utilized a piece of Poplar wood via a cut/sanded 2 x 4 piece of wood. The scrap piece that I used for this project was 2.5" x 12". Any hard wood will work well for this application.

NOTE: In the photo below, the sample on the left was ironed without the clapper applied. The sample on the right was ironed with the wooden clapper used after ironing. The sample on the right is significantly more flat and polished then the sample on the left.



3. Insert the dual feed foot in the sewing machine.
4. To embroider the top of the pocket, select the Embroider Applique stitch #4. Adjust the stitch length and width to 3.0 and 2.5. Adjust the foot tension to 3.4. At a ¼" seam allowance, stitch along the top edge of the pocket with the brown, contrasting thread. Reference the photo below:



ATTACH HANDLES:

1. Using sewing pins, on the right side of the 7" x 9" wool fabric, pin the fabric for the leather handle placement (reference the photo below). The handles are 2 ¼" from the side edge and 1 ½" from the top edge:

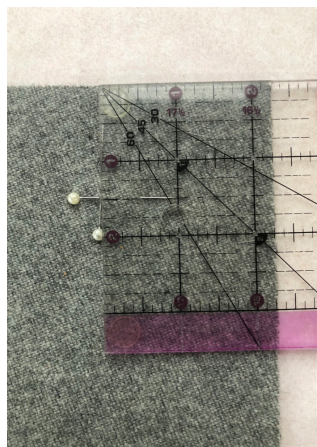

2. For the next step, insert the brown thread in the upper thread spool and grey thread in the bobbin. Utilizing a straight stitch (with the stitch width at 4.5, length at 3.5 and foot tension at 3.40) sew a ½" box stitch to stitch the handle in place:

Mini Wool and Leather Tote



3. Repeat steps 1 & 2 to attach the handles on both pieces of outer fabrics (with 4 total box stitches).

BASTE POCKET:

1. Lay the pocket piece along the bottom edge of one of the 7"x 9" fabrics.



2. Baste the pocket in place along the right and left side edges at $\frac{1}{4}$ " seam allowance. The Baste pre-set stitch is a quick way to complete this step. Reference the tutorial to the stitch below:

Baste pre-set stitch

- a) Select the Garment Icon:

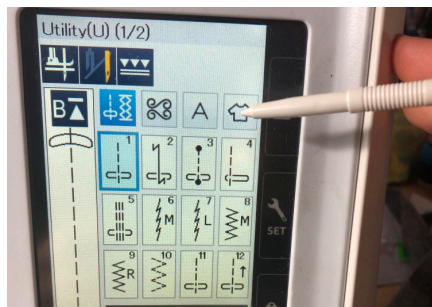

- b) Select the white, right arrow below the screen:

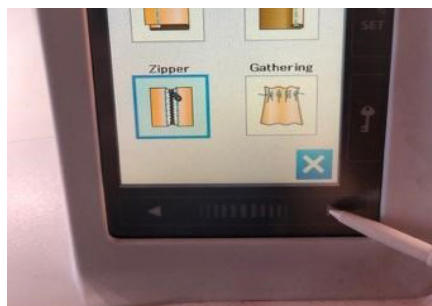

Mini Wool and Leather Tote

c) Select the Basting Icon:

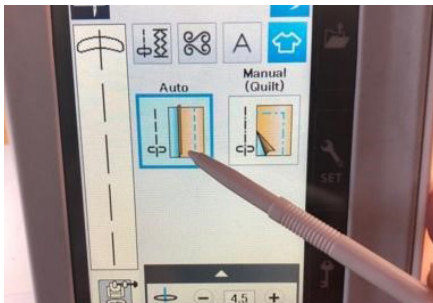

d) Select the Auto Baste Stitch:

ATTACH THE ZIPPER:

1. Mark $\frac{3}{8}$ " from the beginning of the zipper to the edge of the tape (to note the $\frac{3}{8}$ " seam allowance location).

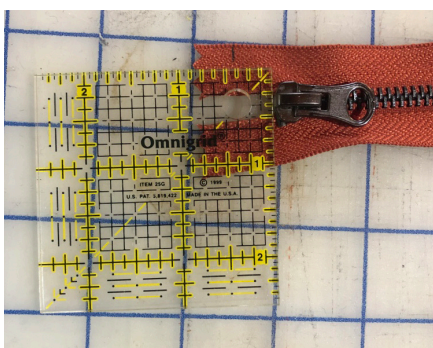

2. Change the top thread spool to grey thread (the bobbin and top thread should both be grey).
3. Select the outer piece that includes the basted pocket.
4. Open the zipper, halfway.
5. Align the wrong side of the zipper to the top edge of the tote. Secure in place with fabric clips.



6. Utilize the zipper pre-set stitch to sew the zipper

Zipper pre-set stitch

a) Select the Garment Icon:

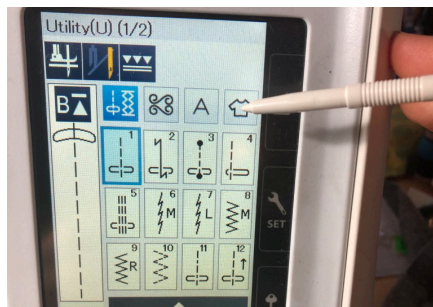

b) Select the Zipper Icon:

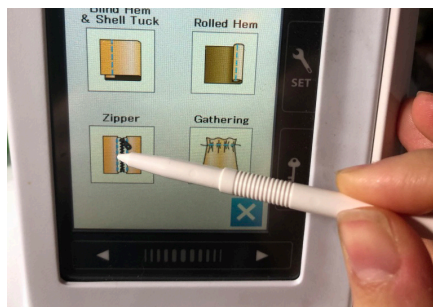

c) Select the Lapped zipper icon:

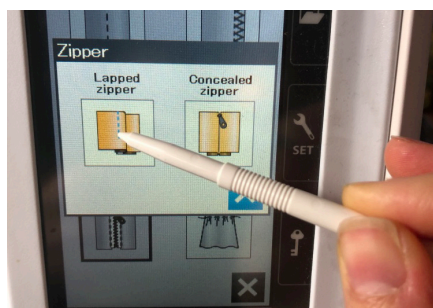

d) Select the Sew Left side icon:

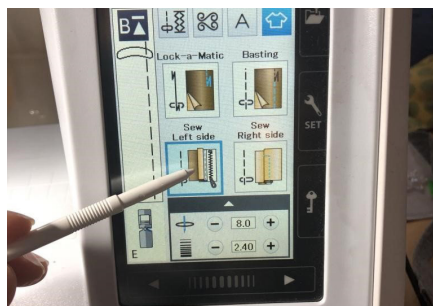

Mini Wool and Leather Tote

- e) Adjust the stitches to a 3.5 stitch length and a 3.8 tension setting



7. Attach Zipper foot E and sew the first zipper seam, at a 1/4" seam allowance:

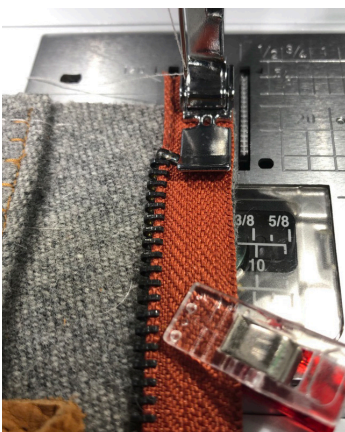

10. Switch to the Sew Right side icon to top stitch the zipper flat. Modify the stitch length to the same as the left side (3.0 long, 3.8 tension):

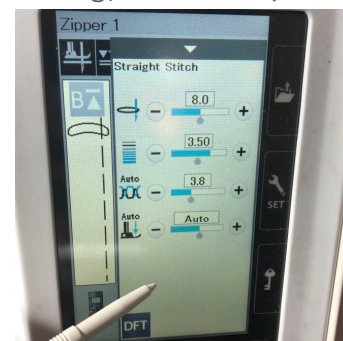
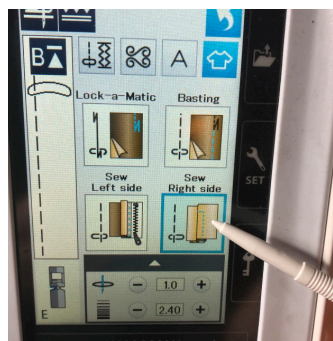

8. With the right side of the zipper facing up (and the zipper opened up halfway again), lay the wrong side of the second tote piece along the other edge of the zipper. Use fabric clips to hold the fabric in place:



9. Lay both of the outer pieces flat, right sides facing.



Mini Wool and Leather Tote

12. Lay the right sides of the tote together. Using fabric clips, align the sides and bottom edges together. Fold the beginning and end of the zipper up so that it is pointing to the lining side of the tote (clip in place).
13. Using a straight stitch (stitch length 4.5 and tension 3.8) at a $\frac{3}{8}$ " seam allowance, sew the sides and bottom edge of the tote.
14. Using the sleeve board and Tailor's Clapper, iron the bottom and side seams flat.
15. Using the 2 $\frac{1}{2}$ " square ruler, cut out 1 $\frac{1}{2}$ " boxes from the bottom corners of the tote:

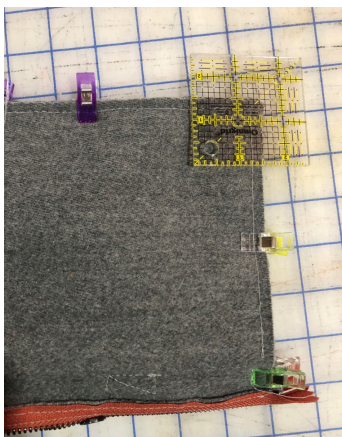

16. Opening the corners of the tote, sew the bottom gusset seams at a $\frac{3}{8}$ " seam allowance. Iron the seams open after sewing.
17. Trim the beginning and end of the zipper tape. Both ends are longer than the tote and will need to be trimmed.



18. To finish a new zipper stop, use the hand sewing needle and thread. Hand tack a new zipper stop to secure the end of the zipper. Fig 32



19. Turn the tote right side out and enjoy!



Mini Wool and Leather Tote